



America's Rose Garden
JOURNAL



2020 Volume 4

America's Rose Garden JOURNAL

2020 VOLUME 4

newsletter for the gardens at the
American Rose Center, Shreveport,
La. Headquarters for the
American Rose Society

IN THIS ISSUE:

- 2 Contents. Christmas in Roseland
- 3 Breaking News! SECOND CIRCLE
- 4 Angel of Hope Candlelight Vigil
- 5 A Visitor's Rose Images
- 6 Great Garden Restoration Update
- 7 Here's How You Can Help
- 7 Donor Recognition Pedestal
- 8 Christmas in Roseland Schedule
- 8 Images from Opening Night 2020 CIR
- 8 America's Rose Garden Information
- 9 ARS and ARC Committee
- 10 Garden Stakeholders, Supporters
- 11 Buy a Brick for the Gardens-form
- 12 Garden Map to Print & Keep



AMERICA'S ROSE GARDEN JOURNAL
is brought to you by the
American Rose Center Committee:

JOURNAL EDITOR:
MARILYN WELLAN

8877 Jefferson Paige Rd., Shreveport, La.
At Exit 5 on US Interstate 20
318-938-5402 www.rose.org



On the cover: Our giant Magnolia Grandiflora abloom
with Christmas lights digitally hung on its branches.

CHRISTMAS IN ROSELAND December Events in the Gardens

The 37th Annual Christmas in Roseland will open with covid-required limitations on the day after Thanksgiving, November 27, and will remain open through December 23, 5:30 to 10:00 p.m. according to the following schedule:

Weekends on Friday, Saturday, Sunday
Nov. 27-29, Dec. 4-6, and Dec 11-13.

From Thursday, December 17 to Wednesday,
December 23, Christmas in Roseland will be open
every night.

Christmas in Roseland Christmas Market will be open
on December 4-5 during CIR evening hours.

A long tradition of "Christmas Cards to the
Community", 4' x 8' paintings by area school children,
will again be a major feature of CIR.

Christmas in Roseland is the major fundraising event of
each year, and provides major support for the gardens
and all facilities throughout the year.

Make plans to attend CHRISTMAS IN ROSELAND
with family and friends again this year.

ANGEL OF HOPE CANDLELIGHT VIGIL

The second annual Angel of Hope Candlelight Vigil
will be held at 6:00 p.m. on December 6th. Musical
performance, poems and prayers of remembrance will
be part of the ceremonies.

See story on the Angel of Hope Sculpture and Garden
and plans for the Candlelight Ceremony with Octavia
on page 4-5.

Breaking news!

We are pleased—and excited—to report that fundraising for the SECOND CIRCLE of our Great Garden Restoration Project is now complete!

That means construction on the important SECOND CIRCLE can begin at the beginning of the New Year! If the history of the installation of the FIRST CIRCLE is a guide, the job should be complete in several months.

The FIRST CIRCLE was begun late in the year 2019, and completed before the year ended. That schedule allowed the roses to be planted optimally, in early spring.

In keeping with the new garden's theme, the "History of the Rose in America", roses in the FIRST CIRCLE are varieties introduced in the 21st Century—hybrid teas, grandifloras, floribundas that were the most frequent winners on the exhibition tables at rose shows across the country, from the year 2000 to the present.

Following our "History of the Rose in America" theme, and going back in time, the SECOND CIRCLE will feature roses of the 20th Century—roses that were introduced between 1900-1999. Throughout most of the 20th Century, through two world wars, a world-wide economic depression, and yes, pandemics, roses captured the hearts of Americans.

The 20th Century might be seen as the Golden Age of Roses, as the American Rose Society was no longer an organization of professional florists, but instead became an organization of individual rosarians and rose gardeners. The "Father of the American Rose Society", J. Horace McFarland came on the scene and brought ARS into the publishing business with the advent of the *American Rose Annual* in 1916. (The 2020 *Annual* is now out, representing our 104th consecutive year of that publication!) Early in the century, American hybridizers began creating roses rather than relying on Europe for varieties; new rose companies and nurseries came on the scene; numerous glossy rose catalogs tempted us with multitudes of beautiful roses, and our rose gardens were brimming with the newest roses as well as old favorites. And, the American Rose Society found its permanent home and headquarters in Shreveport, Louisiana and the gardens were opened.

The SECOND CIRCLE will be 115' in diameter. The brown areas on the perspective drawing are the rose planting beds – totaling 315 linear feet (9' wide), totaling approximately 2,800 square feet of planting beds for roses. The center circle will be a 54' diameter lawn area of grass with some landscaping shrubs added. The number of arbors in this circle have not been determined.

'Peace' Rose



The SECOND CIRCLE will feature these classes of 20th Century roses:

- Hybrid Tea
- Grandiflora
- Floribunda
- Polyantha
- Miniature and Miniflora
- Climber (large-flowered climbers for the arbors)

The THIRD CIRCLE will feature the shrub classes including those that originated in the 19th Century as well as the many modern shrubs that are so popular today.

The FOURTH CIRCLE is planned for Heritage Roses, Old Garden Roses, many of which had their roots in the 18th Century.

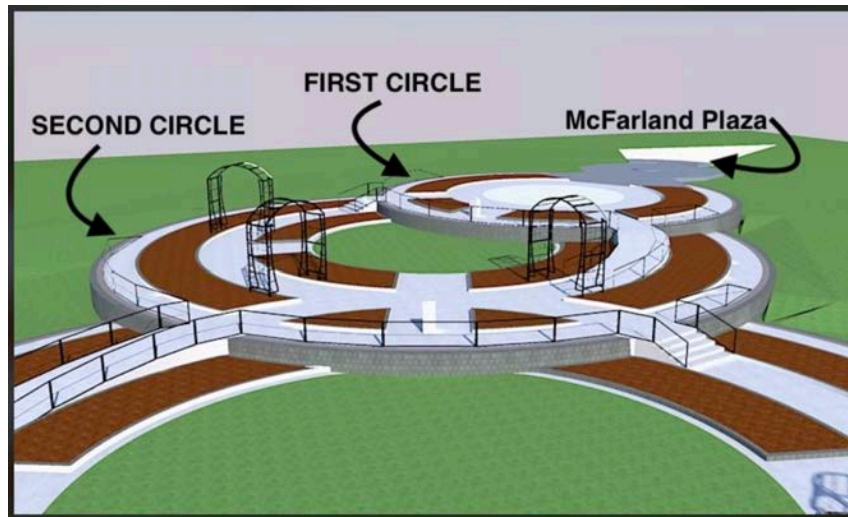

WHAT ARE YOUR FAVORITE ROSES?

Help us tell the "History of the Rose in America". ARS members are invited to participate in the selection of the varieties for the SECOND CIRCLE. The criteria:

1. Roses must be in commerce.
2. Roses from these classes: hybrid tea, grandiflora, floribunda, polyantha, miniature, miniflora, and large flowered climbers (LCI).
3. Roses introduced in 20th Century, 1900-99.
4. Rose preservation is one of the goals of the gardens and the Great Garden Restoration Project; the roses in this garden should be deemed by you to be worthy of preservation.

Send your rose variety nominations to ARC Committee Member Carol Shockley - carol.shockley@conwaycorp.net

When the selection of varieties is complete, we should have a great collection of roses that have performed well for us through the years. We look forward to learning your favorites.

Angel of Hope

Sculpture & Garden

The Angel of Hope sculpture, sometimes known as the Christmas Box Angel statue, was introduced to the world in the book *The Christmas Box*, a worldwide bestseller and television movie by author Richard Paul Evans. In the book, a woman mourns the loss of her child at the base of an angel monument. The story is mostly fiction.

The popularity of the book and the movie prompted the author to commission the angel sculpture by father and son team, Ortho and Jared Fairbanks of Salt Lake City, Utah. Ortho and his wife had lost a child, and found great significance in the creation of the angel.

The Angel of Hope has been reproduced many times in response to reports that grieving parents were seeking out the angel as a place to grieve and heal. The monument was first dedicated on December 6, 1994, corresponding with the date of the child's death in *The Christmas Box* story.

Our Angel of Hope sculpture is the 150th; the sculptures are located in garden sites around the US and abroad. Each site has promised to hold an annual Candlelight vigil for parents, families and friends to remember children who have been lost. Candlelight ceremonies are held on December 6th of every year at each of these locations.

A gift was received for America's Rose Garden for the purpose of purchasing and installing the Angel of Hope Sculpture and Garden. The bronze sculpture measures 4'3" tall with a wingspan of 5'2". The overall height is 9' with base. It is located in a serene setting of towering pines in the "Tranquility" section of America's Rose Garden.

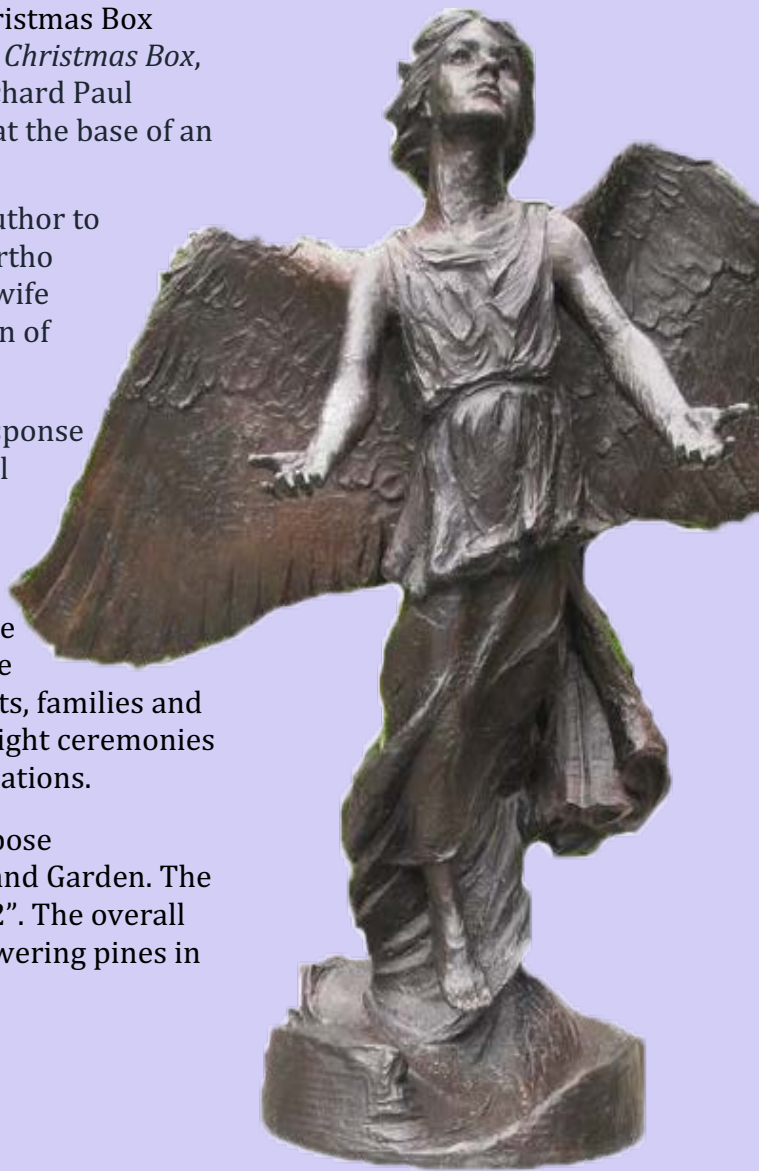

*Angel of Hope Candlelight Ceremony
Featuring Performing and Recording Artist*

Octavia

*Join us for music, poetry and
prayers of remembrance
in the Rose Garden by Candlelight,
outdoors & socially distanced.*

Sunday, December 6th at 6 pm



Octavia is coming to the gardens! Hallelujah!

Octavia began singing at an early age. Over the past twenty years, she has developed a loyal following among audiences across culturally diverse communities. She continues to inspire listeners with her unique style, which includes gospel, inspirational and pop music.

Octavia's many interests include volunteer service on charity boards and for the Central Louisiana Community, however, her passions are God and music; her journey includes spreading the gospel with her voice, as a recording artist, and as a worship leader. When Octavia sings, everyone agrees her performances are both powerful and uplifting.

A RECENT VISITOR TO THE GARDENS SHARED THESE LOVELY ROSE IMAGES



Do you know this rose? Please email me. Editor
roseusa@suddenlink.net



Wishing everyone a very Merry Christmas and Happy, Healthy and Rosy New Year.

AMERICA'S ROSE

GARDEN'S

Great Garden Restoration Project Update

We hope you have been following the progress of the Great Garden Restoration in *American Rose* magazine, and on this editor's Facebook page.

PHASE I (2017-18)

We cleared the pines, installed a 4000+ foot deer fence, laid new concrete walkways through the core garden, consolidated the outlying gardens, created a Master Plan, added the Wellan Lawn Terrace & Stairs, added the Shanley-DelVecchio Pavilion, secured the garden design and raised over one-half million dollars toward our goal of \$1.4 Million.

PHASE II (2019)

Several satellite gardens were developed including the Peace Family of Roses Garden, the Members' Choice Garden, the Miniature-Miniflora Garden, the Angel of Hope Sculpture Garden, the Shreveport-Bossier Rose Society Garden. We engaged the building contractor and completed the installation of the FIRST CIRCLE. Additional funds raised in 2019 brings the project total raised to \$1.2 million. The America's Rose Garden Advisory Board was created and held their first meetings.

PHASE III (2020)

As reported earlier, we are happy that fund raising for the SECOND CIRCLE is now complete!

Projects completed and underway in Phase III include:

- Installation of total irrigation system underway.
- Plan developed for "Fertigation" system.
- Extensive planting of landscaping of trees & shrubs.
- New roses are planted in most gardens.
- The Deep South District Garden has been greatly expanded to include a planting of all ten of the 'Knock Out' roses series.
- New 'Never Forget Garden'
- Cleo Barnwell Garden of Pollinators & Rose Companions gets a new cottage fence.
- Labeling of all roses complete
- Labeling of trees & shrubs underway
- Open areas of Core Garden graded and seeded
- Air conditioning replaced and/or upgraded
- Electrical work on grounds and at wells
- Dead trees removed
- Gravel for back parking lot
- 'Gator' vehicle with sprayer purchased
- 45 gallon spray tank purchased
- Zero-turn mower purchased
- Chainsaws (2) purchased
- String trimmers (2) purchased

- 45 gallon spray tank purchased
- Zero-turn mower purchased
- Chainsaws (2) purchased
- String trimmers (2) purchased
- Edgers (2) purchased
- Hand blower & backpack blowers purchased
- Trailer purchased
- Windsounds painted and restored
- Train Station & Restrooms painted
- Additions to Christmas lighting displays for Christmas in Roseland
- Charles Beaird Hall and Virginia Shehee Hall at Klima Rose Hall – getting new carpet, paint, light fixtures, kitchen equipment and additional design elements
- New flooring for the Hardtner Chapel

All of the above purchases, improvements and additions, and those to come, make up the largest, most ambitious investment in the gardens at the American Rose Center in our near fifty-year history.

We have been able to accomplish these projects with a remarkably small garden staff, thanks to the leadership of ARS Executive Director Jon Corkern. He has provided unprecedented skill, ingenuity, energy and drive to the Restoration, balancing many major garden projects at the same time, all the while he is managing the affairs of the Society.

Garden Director Don Morgan has led his team with the same commitment to the goals of the Restoration – that is, to create the very best rose garden we possibly can, within budget, **without any expense to the Society.**

We want to especially thank ARS President Robert Martin and the Board of Directors for believing in the value of the gardens to our members, and it's importance to the Rose itself. That dedication to the success of the Restoration has been unwavering; that commitment is greatly appreciated.

America's Rose Garden is on the way to being a great Botanical Garden, thanks to ARS leaders, members, societies and districts, to local support, and to the American Rose Center Maintenance Endowment Fund. Generous contributions to the endowments and wise investments through the years have made the gardens possible; it will continue to sustain the gardens through the years ahead.

PHASE IV (2021)

Phase IV will see the installation and completion of the SECOND CIRCLE; and we are launching the fund-raising drive for the THIRD CIRCLE. A pledge has been received for funding for 40% of the THIRD CIRCLE, though the garden is still available as a naming opportunity for 100% funding. We are well along in the Restoration project, money-wise and goals accomplished. We must maintain the momentum gained and get the THIRD CIRCLE funded and installed, after which the FOURTH CIRCLE will surely follow.

Let's Continue the Progress. . . .

. . . . here's how you can help.

- \$100— 4" x 8" Engraved Brick (see brick order form, p.14)
- \$200— 8" x 8" Engraved Brick (for a larger message).
- \$500— Hug a Tree. Gift will be recognized on tree label and on Donor Wall.
- \$500— 30" Ceramic Planter for container-grown rose. Gift will be recognized on plant label and on Donor Wall.
- \$1,500— Teak Garden Bench Gift will be recognized on engraved marker and on Donor Wall.
- \$1,500— Engraved 18" x 18" Ceramic Tile in Klima Rose Hall/Whitaker Hall. Gift will be recognized on the tile and on Donor Wall.
- \$3,000— Rose Arbor in SECOND CIRCLE. Gift will be recognized on garden label and on Donor Wall.
- \$10,000+ Significant contribution to THIRD CIRCLE - Recognition on Donor Pedestal and on Donor Wall.

Donations of *every* size are welcome and will be most appreciated. Pledges and gifts of stock and real estate property are welcome as well. We will probably accept your car when you wish to depart with it!

We will be happy to entertain any proposal for naming rights to gardens, parts of gardens, planting beds, groves of trees, walks, garden décor and works of art; you can be creative with your gifting. All donations are recognized in *American Rose*.

For example, the Peace Family of Roses Garden could have a donor's name in the front of the garden's title. The same is true for the Members' Choice Garden, the Miniature-Miniflora Garden, the Wedding Ring Garden near the Hardtner Chapel, and others.

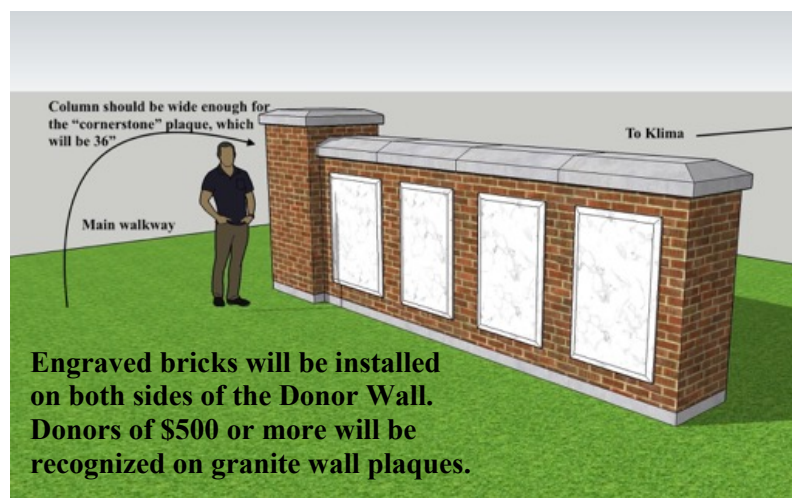

See next to last page for order form for engraved bricks. We will be happy to talk with you about options for giving to the Great Garden Restoration Project. Please send an email to discuss your ideas to

- Dr. Jim Hering rosehering@roadrunner.com,
- Jon Corkern executivedirector@rose.org
- Lucy Medvec lucy@rose.org
- Marilyn Wellan roseusa@suddenlink.net

Thank you!

GRANITE DONOR PEDESTAL FOR ALL CIRCLES



As we move toward building a fund to install the THIRD CIRCLE for AMERICA'S ROSE GARDEN, we want to pause, to honor and show our great appreciation to those who have supported the Great Garden Restoration Project since 2017.

Your generous gifts to the Gardens have enabled us achieve so many of our goals, and to complete the installation of the FIRST CIRCLE last year, where we planted the great roses of the 21st Century.

Our majestic donor pedestal is granite, 40" high and 14" square with an easy-to-read slanted top. It faces the part of the garden that will soon be the center of the SECOND CIRCLE which we are now ready to build. All four circles will honor donors with granite pedestals as shown above.

This donor pedestal in the FIRST CIRCLE is engraved in memory of Dr. Charles and Carolyn Beaird whose Advised Fund in the Community Foundation of North Louisiana went a long way toward making the 2019 installation possible. Dr. Beaird was a long-serving Chairman of the American Rose Center Maintenance Endowment Trust, and a long-time supporter of the gardens.

Other major donors who helped to fund the FIRST CIRCLE are Robert Myers, Jack Page, Dr. Jim and Anne Hering, Frank and Flora Hover, Allen Owings, Collin County Rose Society, Bob Martin and San Diego Rose Society; and we recognize the gifts by many members of the ARS whose donations combined to allow us to complete the installation.

Thanks to everyone who loves roses so much they are willing to preserve and present them to the public in our beautiful America's Rose Garden by their generous gifts to the Gardens.

Calendar . . .

Christmas in Roseland - 2020

- NOVEMBER 19 CHRISTMAS IN ROSELAND VIP & MEDIA PREVIEW
- NOVEMBER 19 CHRISTMAS CARDS TO THE COMMUNITY
- NOVEMBER 27-29 CHRISTMAS IN ROSELAND OPEN
- DECEMBER 4-13 CHRISTMAS IN ROSELAND OPEN
- DECEMBER 4- 5 ROSELAND CHRISTMAS MARKET
- DECEMBER 6 ANGEL OF HOPE CANDLELIGHT VIGIL 6 PM
- DECEMBER 17-23 CHRISTMAS IN ROSELAND OPEN ALL NIGHTS

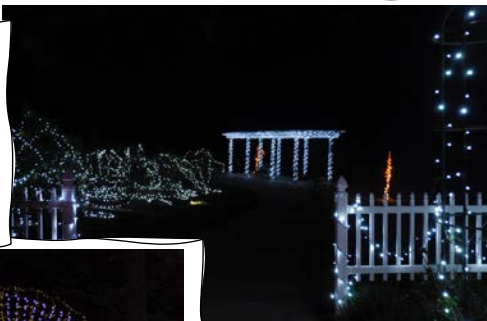

GARDEN INFORMATION

The gardens are conveniently located north of Interstate 20 at exit 5 on Jefferson Paige Road – just 5 miles from the state of Texas, and about 5 miles from the city limits of Shreveport, La. Watch for highway signage.

GARDEN SEASON

April through October

GARDEN DAYS & HOURS

during Garden Season

Monday-Saturday 9am-5pm
Sunday 1pm-5pm

GARDEN- A WALKING PATH

What could be better for you or more beautiful than a walk or jog along our garden paths. Gardens are open for walking all seasons. Dogs on leashes are welcome.

GARDEN ADMISSION

We love that we are able to offer admission to the garden **by donation - \$5 minimum** is encouraged for adults. We will be able to continue this practice as long as we have generous guests. Guests must enter through the front entrance of Klima Rose Hall and check in at the gift shop.

HERING GIFT SHOP

The Jim and Anne Hering Gift Shop is open during garden hours. You will find lovely rose and garden-related items, stationary, textiles, home and garden décor, scents, children's items, books, bottled water, light refreshments, and more.

REST ROOMS

Klima Rose Hall offers spacious restrooms, always in tip-top shape.

COVID RESPONSIBLE – Please wear masks and maintain social distancing. We want our visitors to be safe out there.

VOLUNTEER DAYS at ARG

October 23 and 24 were outstanding Volunteer Days in the Garden, with close to 50 people turnout out to help winterize the gardens over the two days, while remaining socially distanced.

We especially appreciate ARGENT FINANCIALS whose employees were a formidable and very welcome task force. It was fun working with them, and we look forward to more days in the future. Also Shreveport-Bossier Rose Society members and Ark-La-Tex Herb Society provided much needed help.

Next Volunteer Days – Feb. 12-13 — when IT'S ROSE PRUNING TIME!



THE AMERICAN ROSE SOCIETY

ROBERT B. MARTIN, JR. – President
DIANE SOMMERS – Vice President
JACK PAGE - Treasurer
JON CORKERN – ARS Executive Director
DON MORGAN – ARG Garden Director

CONTACT INFORMATION
American Rose Society/American Rose Center
P. O. Box 30,000, Shreveport, La. 71130
8877 Jefferson-Paige Rd, Shreveport, La. 71119
Phone 318-938-5402 - www.rose.org

THE AMERICAN ROSE CENTER COMMITTEE & MISSION

CLAUDE GRAVES –	Chairman, Founding member, Richardson TX
DR JOE WHITE -	Chairman Emeritus, Former LSU Ag Horticulture Agent, Shreveport LA
ROBERT B. MARTIN, JR.	Ex-Officio Member as ARS President
PAM BRADLEY –	Shreveport-Bossier RS President, Shreveport LA
FRANK HOVER -	Committee-Garden Liaison, Bossier City LA
DAVID LONG –	Construction Project Coordinator, Old Lyme CT
DR ALLEN OWINGS –	Former LSU AgCenter Research Horticulturist, Hammond LA
CONNIE REEVE –	Chair of Permanent Jury for Rose Trials, Henderson TX
CAROL SHOCKLEY -	Special Projects Coordinator, Conway, AR
MARK WALTON –	Garrison's Greenwood Gardens, Shreveport LA
MARILYN WELLAN –	Great Garden Restoration Coordinator, Alexandria LA
BAXTER WILLIAMS -	Founding member, Houston TX
PATSY WILLIAMS -	Houston TX
MARK WILSON –	LSU AgCenter Horticulture Agent for NW La.

The American Rose Center Committee advises the staff of the American Rose Center on horticultural issues and planning for the Center. The Committee focuses on planning and implementation of actions to make the American Rose Center's gardens increasingly diverse, interesting and representative of rose culture within the limits of the Center's budget.

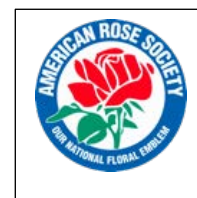

The American Rose Center Committee meets quarterly, and frequently via electronic media.

AMERICA'S ROSE GARDEN ADVISORY BOARD



KAREN HARDTNER, Chair
ELIZABETH DAVIS, Co-Chair
WINZER ANDREWS
NELL CAHN
MICHAEL D. CORBIN
JON CORKERN, ARS Exec. Director
ANDREW CRAWFORD
MARLETTA EDDY
SYLVIA GOODMAN
SUSAN HARDTNER
CHRIS JAY

JUDY KINSEY
CONG. JIM MCCRERY
MARGARET MARTIN
ROBERT B. MARTIN, JR. ARS President
GRANT NUCKOLLS
KATHY RASBERRY
JOANNA ROBINSON
LAURA SEABAUGH
MARILYN WELLAN, ARC Coordinator, Liaison
MICHELE WIENER

Every Botanical Garden/Public Garden has STAKEHOLDERS. The stakeholders for the American Rose Center are 1) Members of the American Rose Society, and 2) Members of the Community of Shreveport and surrounding area. The AMERICA'S ROSE GARDEN ADVISORY BOARD was created in 2019 to represent the Community, to serve as "Ambassadors" for the Gardens, and to advise, propose, and seek support for the Gardens from area resources and organizations. ARS President Bob Martin is ex-officio member of the Board.

AMERICA'S ROSE GARDEN

The Garden's theme: "THE HISTORY OF THE ROSE IN AMERICA."
THE AMERICAN ROSE SOCIETY sincerely appreciates the donation
of the original Restoration garden design by this friend of the gardens:



OUR SINCERE THANKS TO OUR PARTNERS IN ROSES – THESE GENEROUS SUPPORTERS:

ROSE GARDEN PARTICIPATION:

RICHARD ANTHONY
CLYDE & MARIE BARTLETT
BEATY FERTILIZER,
CLAYTON & JOHN BEATY
CHRISTIAN BEDARD, WEEKS ROSES
CONARD-PYLE, HSE OF MEILLAND
DR. JIM HERING
PING LIM, ALTMAN PLANTS
MEILLAND HOUSE OF ROSES, STAR
WILL RADLER, STAR ROSES
SHREVEPORT-BOSSIER ROSE SOC.
JIM SPROUL, STAR ROSES
CHRIS WARNER, SPRING MEADOW

ROSES:

DAVID AUSTIN ROSES, LTD
K & M ROSE NURSERY
HIGH COUNTRY ROSES
LYNN ANDERSON GARDEN
NORTHEAST LA. ROSE SOCIETY
STAR ROSES & PLANTS
WEEKS ROSES
WITHERSPOON ROSE CULTURE

LANDSCAPE PLANTS:

CHAMBERSVILLE TREE FARMS,
DEAN & CAROL OSWALD
KEN KELLEY
DR. ALLEN OWINGS
MARILYN WELLAN
DR. BUD WILLIS

Help us build the Third Circle of the Great Garden Restoration Project

Your name / message permanently engraved on a brick in the garden or on a porcelain tile in Klima Rose Hall.

Our commemorative Brick Pavers and Porcelain Tiles provide individuals, families and businesses, societies, districts and organizations an opportunity to be a part of the GREAT GARDEN RESTORATION PROJECT. Honor or recognize family members, friends and associates, or commemorate your special events. The bricks and pavers will provide permanent recognition of your gift in support of America's Rose Garden.

For credit card orders of BRICKS or PORCELAIN TILES, phone 318-938-5402 x 223, or email Carol Spiers carol@rose.org. Or mail this form with your check to:

American Rose Society
P. O. 30,000 ~ Shreveport, La. 71130-0030

ENGRAVED BRICK 4 X 8 - \$100

Includes engraving up to 39 characters. 3/4" lettering. 3 lines per brick; up to 13 Characters per line, including spaces.

ENGRAVED BRICK 8 X 8 - \$200

Includes engraving up to 52 characters; 3/4" lettering. 4 lines per brick; up to 13 characters per line, including spaces.

(4TH Line for 8 X 8 Brick Only)

ENGRAVED PORCELAIN TILE IN KLIMA ROSE HALL 18 X 18 - \$1,500

Includes engraving up to 90 characters. 1" lettering. Up to 6 lines per tile. Up to 13 characters per line, including spaces.

Thank you for purchasing personalized bricks or pavers for installation at America's Rose Garden. Your gift will help in the Restoration, and will especially help us install the Third and Fourth Circles of the new gardens.

If there are other areas of the garden you wish to contribute to, or if you are interested in learning about naming opportunities, please contact me at roseusa@suddenlink.org.

Marilyn Wellan

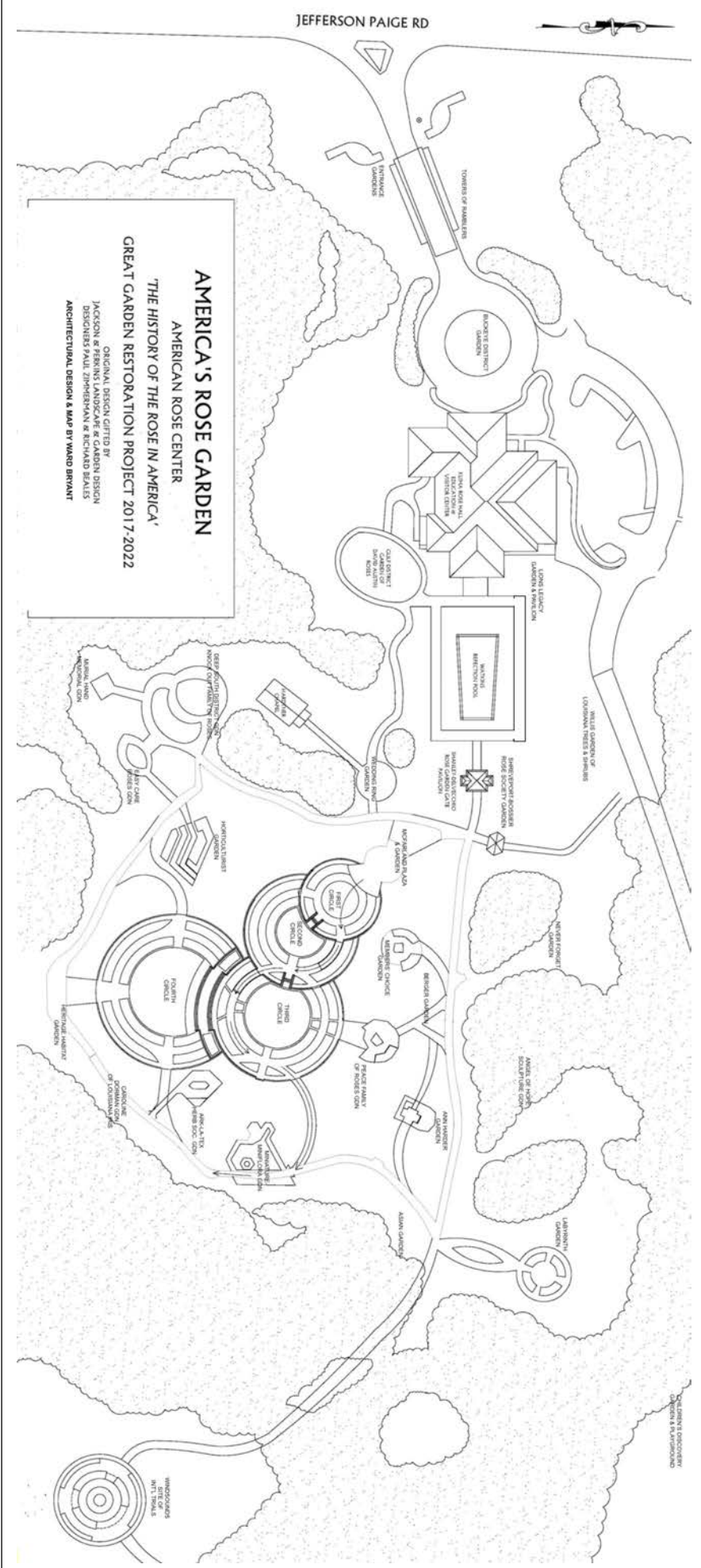

AMERICA'S ROSE GARDEN

MAP OF THE GARDENS

TO PRINT & KEEP

We will soon be able to create a garden map for visitors to direct them through the gardens in an organized way, or guide them to a specific area of the gardens.

GARDEN GROUPS

ENTRANCE GARDENS

- Sign Garden
- Entrance Gate Gardens
- Towers of Ramblers
- Buckeye District Garden

KLIMA GARDENS

- Gulf District Gdn of Austin Roses
- Owings Ginkgo Alee at reflection pool
- Lions Legacy Garden
- Garden of Louisiana Trees & Shrubs
- Shreveport-Bossier Rose Soc Gardens

HARDTNER CHAPEL GARDENS

- Wedding Ring Garden
- Mary Johnston Garden
- Cong. Lindy Boggs Garden

WATCHWORKS GARDENS – CORE GARDEN

- McFarland Plaza & Garden
- Members' Choice Garden
- Peace Family of Roses Gdn
- Miniature-Miniflora Garden
- The Four Circles

SUSTAINABILITY GARDENS

- Ark-La-Tex Herb Soc. Gdn
- Caroline Dorman Garden of La. Iris
- Heritage Habitat Garden
- Cleo Barnwell Pollinator Garden
- Horticulturist Garden
- Easy Care Roses Garden
- Deep South Dist. Garden of Knock Out Family of Roses
- Muriel Hand Memorial Garden

ASIAN GARDENS

TRIAL GARDENS at WINDSOUNDS

TRANQUILITY GARDENS

- Never Forget Garden
- Angel of Hope Sculpture Garden
- Labyrinth Garden
- Berger Garden
- Ann Harder Garden

CHILDREN'S DISCOVERY GARDEN & PLAYGROUND